

HSL VLT Series

2x2 & 2x4 LED Troffer

FEATURES & SPECIFICATIONS

INTENDED USE

The HSLVLT offers excellent luminaire - subtle soft direct elements, provide an interesting illumination and depth across the ceiling plane - with a contemporary look that blends with today's commercial spaces.

The extruded acrylic lens with softening overlay provides a low brightness glow, with the effective combination of excellent light transmission and low glare. Even illumination over the entire face.

APPLICATIONS

For recessed commercial applications such as offices, hospitals, schools, etc. Suitable for use in standard inverted T-bar grid ceilings.

FEATURES

- High reflectance optical engine delivers main beam focus through the optically designed acrylic lens
- Linear ribbed acrylic lens with Lumieo overlay manages the balance of efficiency and aesthetics
- Reflector distributes light through both optical elements
- Linear arrayed LED modules provide soft, but effective illumination

SPECIFICATIONS

HOUSING

Low Profile body with matte white sloped side members

DIFFUSER SURROUND

Linear ribbed acrylic lens with Lumieo

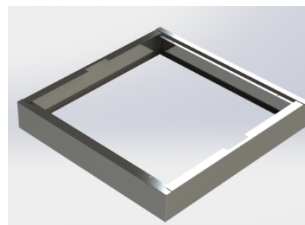

Optional Shroud for surface mounted.



LED Troffer with Integrated Sensor

LUMINAIRE TYPE

Recessed troffer fixture - body assembly size options: 2'x2' and 2'x4'

ORDERING INFORMATION

STANDARD

VLT	22L	F24W2400L	DMV	40K	
Series	Size	Wattage and Lumen	Driver	Color Temperature	OPTIONS
HSL VLT LED Troffer	22L 2' x 2'	F24W2600L 24 System Watts, 2600 Delivered Lumens F28W3000L 28 System Watts, 3000 Delivered Lumens	DMV 0-10V Dimming *Field installed-Dimming Wire DMVFID 0-10V Dimming *Factory installed-Dimming Wire	30K 3000K 35K 3500K 40K 4000K 50K 5000K	GK1 Single Gasketed Door - Single (lens to door frame) GK2 Double Gasketed Door - (lens.frame +
HSL SSVLT LED Troffer Sensor - On/Off					
HSL SDVLT LED Troffer Daylight Sensor	24L 2' x 4'	F35W3650L 35 System Watts, 3650 Delivered Lumens F48W5400L 48 System Watts, 5400 Delivered Lumens F56W6050L 56 System Watts, 6050 Delivered Lumens			

Example: HSL VLT22LF24W2400LDMV40K

HSL VLT Series

END PROFILE

2x2 & 2x4 LED Recessed Troffer

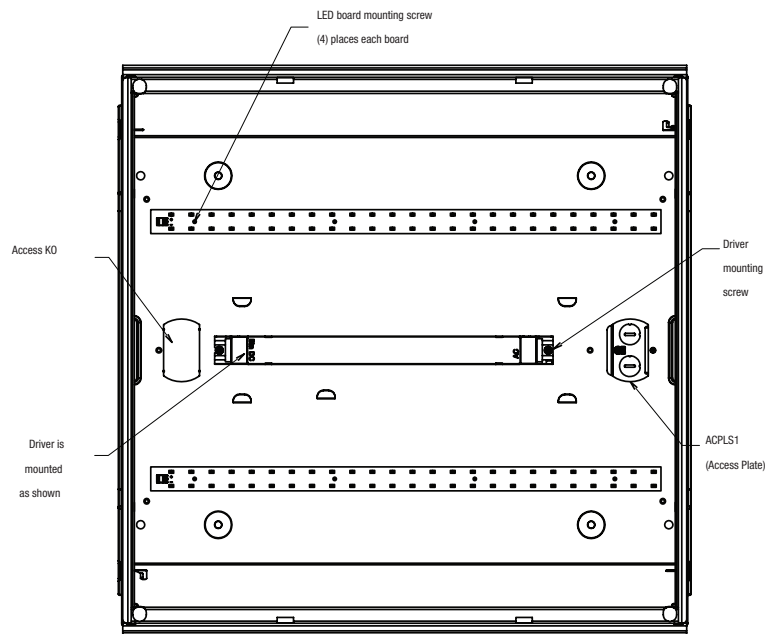
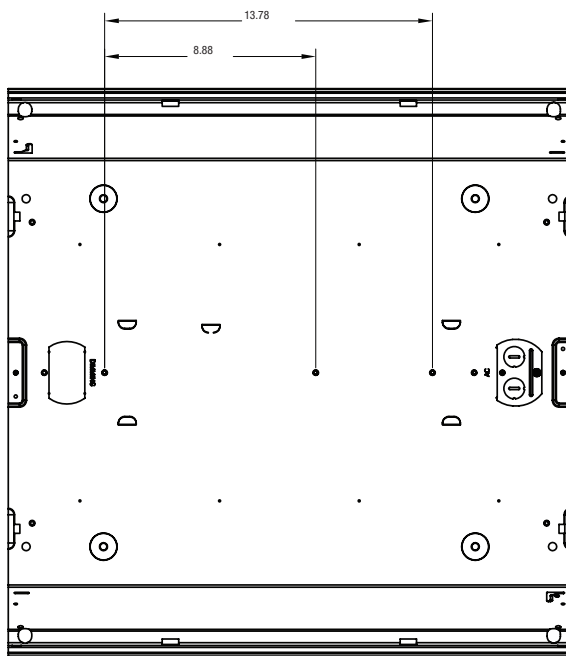
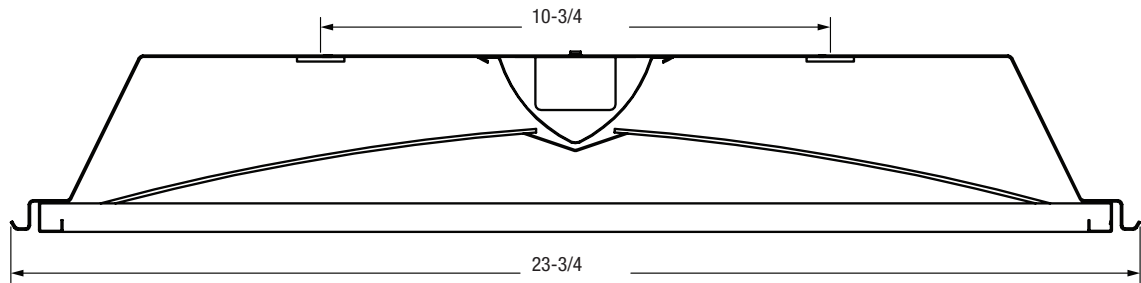

HSL VLT Series

2x2/2x4 LED/FLUOR

LED Recessed 2' x 2' Troffer Installation Instructions

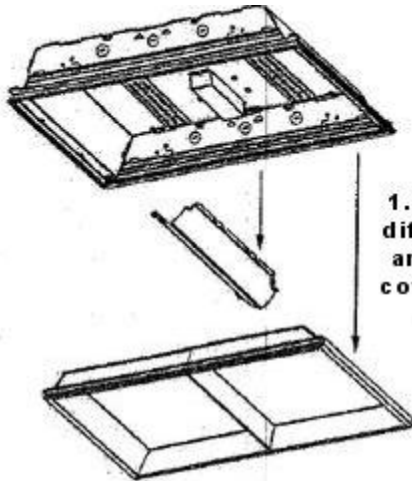

**1. Remove louver/
diffuser assembly
and center driver
cover from fixture.**

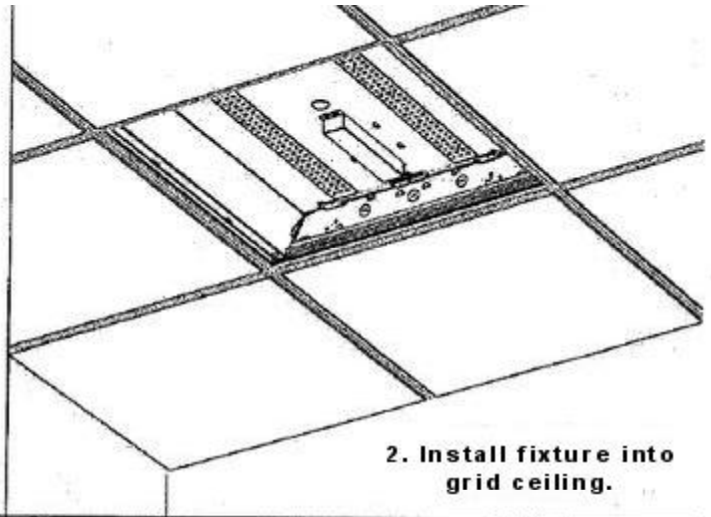

**2. Install fixture into
grid ceiling.**

**Make sure power is turned off at the source
to the troffer housing.**

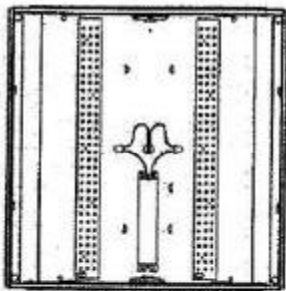

2 boards

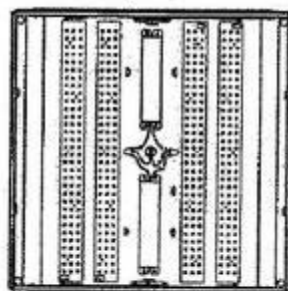

4 boards

**3. Bring electric power cord in through back of
fixture. Using wire nuts, connect cord leads to
LED driver input wires (black/white). Driver
can be connected to 120-277V AC input.**

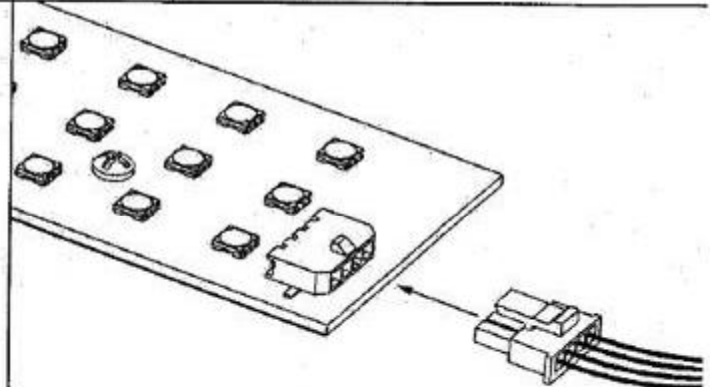

**4. Ensure all microconnectors are attached
to LED circuit boards.**

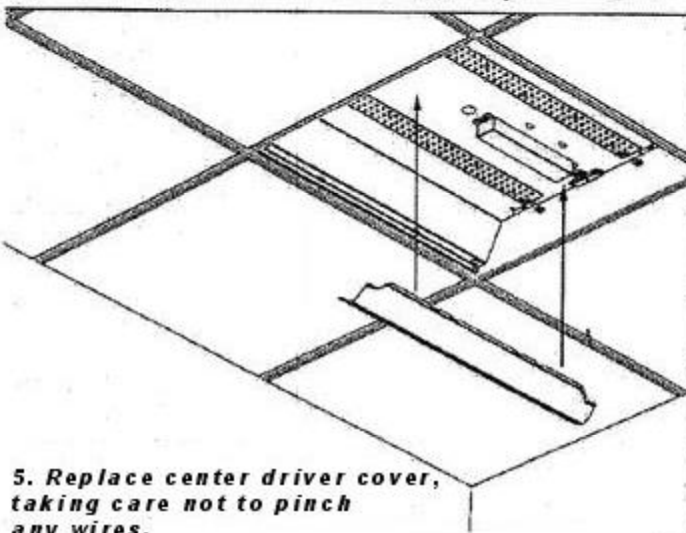

**5. Replace center driver cover,
taking care not to pinch
any wires.**

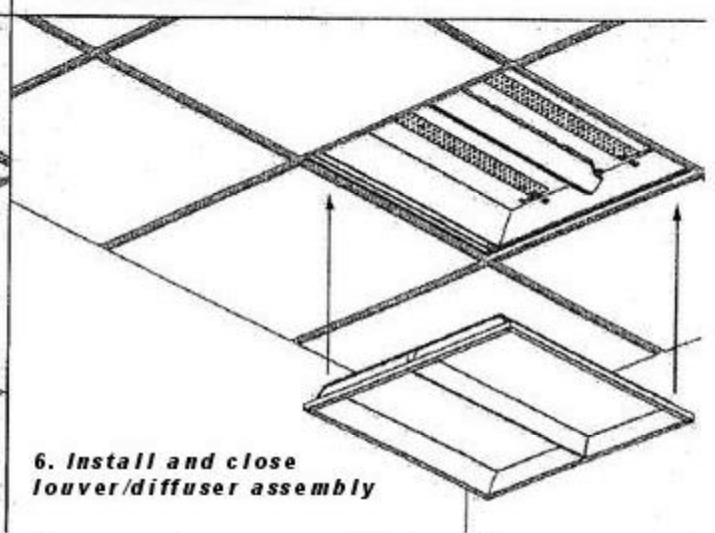

**6. Install and close
louver/diffuser assembly**

7. Restore power to fixture at fuse or circuit breaker.